



Underwriters Laboratories, Inc.
Recognized Component Program — UL File Number E201546

UL file number E201546 has been assigned to Keystone Electronics' "Quick-Fit" terminals (Refer to pages 44-47) indicating recognition by Underwriters Laboratories Inc. that they are in compliance with their component program.

Underwriters Laboratories Inc. component program assures that "Quick-Fit" terminals meet the dimensional and performance requirements of the National Electrical Manufacturers Association specification number NEMA2-1982-(1988) and UL310.



.110 (2.8), .187 (4.8), .205 (5.2) MALE TABS

.110 (2.8) TAB

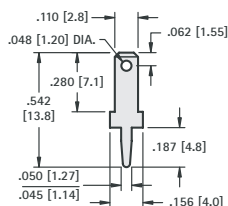

CAT. NO.	MATERIAL	MTG. HOLE
1267	.020 (.50) Brass, Tin Plate	.046 (1.2) Dia.
1211	.032 (.80) Brass, Tin Plate	.052 (1.3) Dia.

.110 (2.8) TAB

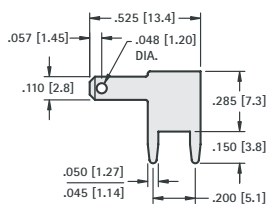

CAT. NO.	MATERIAL	MTG. HOLES
4903	.020 (.50) Brass, Tin Plate	.046 (1.2) Dia.
4906	.032 (.80) Brass, Tin Plate	.052 (1.3) Dia.

.187 (4.8) TAB

STURDI-MOUNT

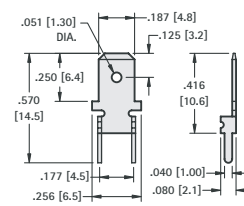

CAT. NO.	MATERIAL	MTG. HOLES
4900	.020 (.50) Brass, Tin Plate	.043 (1.1) Dia.

.187 (4.8) TAB

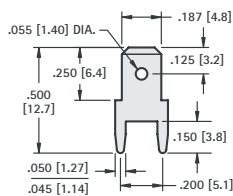

CAT. NO.	MATERIAL	MTG. HOLES
1285	.020 (.50) Brass, Tin Plate	.046 (1.2) Dia.
1212	.032 (.80) Brass, Tin Plate	.052 (1.3) Dia.

.187 (4.8) TAB

STURDI-MOUNT

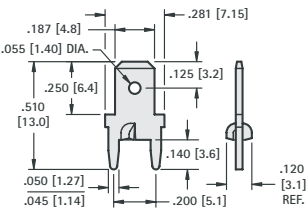

CAT. NO.	MATERIAL	MTG. HOLES
1285-ST	.020 (.50) Brass, Tin Plate	.046 (1.2) Dia.
1212-ST	.032 (.80) Brass, Tin Plate	.052 (1.3) Dia.

.187 (4.8) TAB

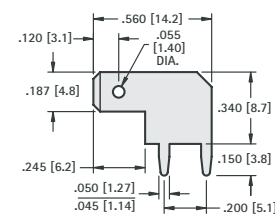

CAT. NO.	MATERIAL	MTG. HOLES
4904	.020 (.50) Brass, Tin Plate	.046 (1.2) Dia.
4907	.032 (.80) Brass, Tin Plate	.052 (1.3) Dia.

.205 (5.2) TAB

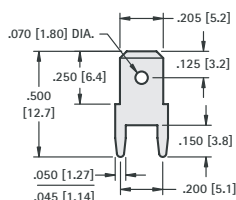

CAT. NO.	MATERIAL	MTG. HOLES
1286	.020 (.50) Brass, Tin Plate	.046 (1.2) Dia.
1213	.032 (.80) Brass, Tin Plate	.052 (1.3) Dia.

.205 (5.2) TAB

STURDI-MOUNT

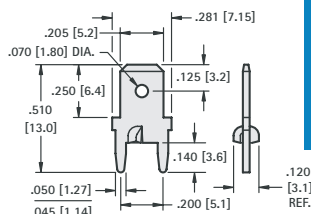

CAT. NO.	MATERIAL	MTG. HOLES
1286-ST	.020 (.50) Brass, Tin Plate	.046 (1.2) Dia.
1213-ST	.032 (.80) Brass, Tin Plate	.052 (1.3) Dia.

.205 (5.2) TAB

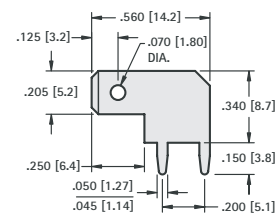

CAT. NO.	MATERIAL	MTG. HOLES
4905	.020 (.50) Brass, Tin Plate	.046 (1.2) Dia.
4909	.032 (.80) Brass, Tin Plate	.052 (1.3) Dia.



.250 (6.4) TAB

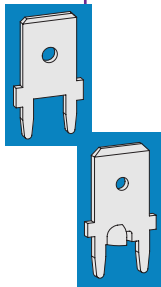
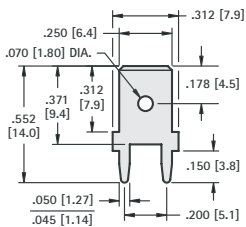

.250 (6.4) TAB

STURDI-MOUNT

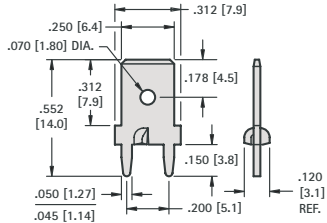

DUAL .110 (2.8)/.250 (6.4) TAB

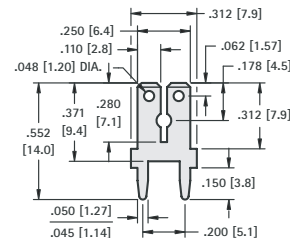

CAT. NO.	MATERIAL	MTG. HOLES
1287	.032 (.80) Brass, Tin Plate	.052 (1.3) Dia.

CAT. NO.	MATERIAL	MTG. HOLES
1287-ST	.032 (.80) Brass, Tin Plate	.052 (1.3) Dia.

CAT. NO.	MATERIAL	MTG. HOLES
1282	.032 (.80) Brass, Tin Plate	.052 (1.3) Dia.

.250 (6.4) TAB

STURDI-MOUNT

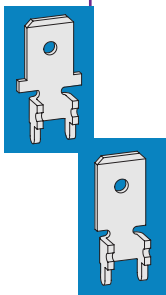
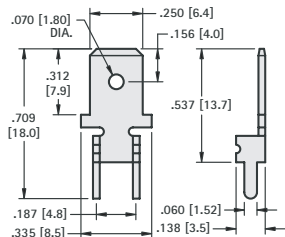

.250 (6.4) TAB

STURDI-MOUNT

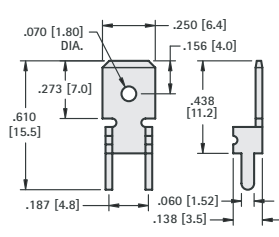

.250 (6.4) TAB

STURDI-MOUNT

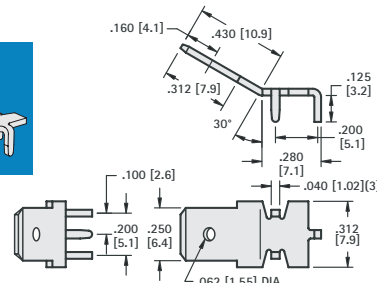

CAT. NO.	MATERIAL	MTG. HOLES
4901	.032 (.80) Brass, Tin Plate	.067 (1.7) Dia.

CAT. NO.	MATERIAL	MTG. HOLES
4902	.032 (.80) Brass, Tin Plate	.067 (1.7) Dia.

CAT. NO.	MATERIAL	MTG. HOLES
4908	.032 (.80) Brass, Tin Plate	.067 (1.7) Dia.

.250 (6.4) TAB

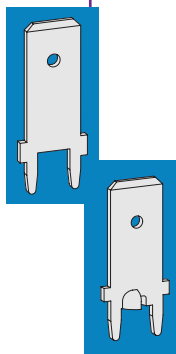
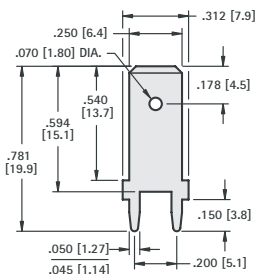

.250 (6.4) TAB

STURDI-MOUNT

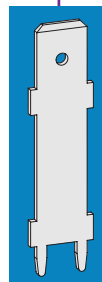
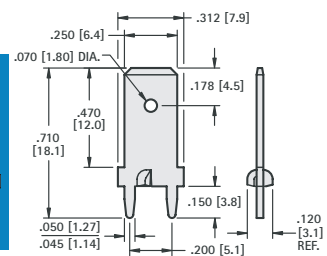

.250 (6.4) TAB

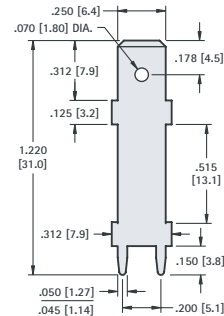

CAT. NO.	MATERIAL	MTG. HOLES
1289	.032 (.80) Brass, Tin Plate	.052 (1.3) Dia.

CAT. NO.	MATERIAL	MTG. HOLES
1289-ST	.032 (.80) Brass, Tin Plate	.052 (1.3) Dia.

CAT. NO.	MATERIAL	MTG. HOLES
1281	.032 (.80) Brass, Tin Plate	.052 (1.3) Dia.

.250 (6.4) TAB

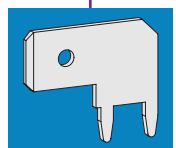
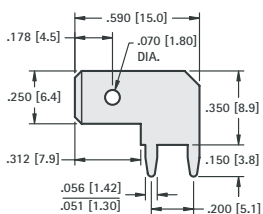

.250 (6.4) TAB

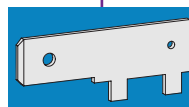
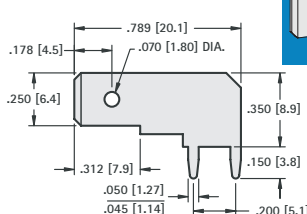

.250 (6.4) TAB

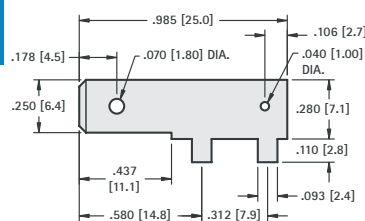

CAT. NO.	MATERIAL	MTG. HOLES
4966	.032 (.80) Brass, Tin Plate	.056 (1.4) Dia.

CAT. NO.	MATERIAL	MTG. HOLES
1266	.032 (.80) Brass, Tin Plate	.052 (1.3) Dia.

CAT. NO.	MATERIAL	MTG. HOLES
1265	.032 (.80) Brass, Tin Plate	.106 (2.7) Dia.

NOTE: .250 TAB HAND INSERTION TOOL: CAT. NO. 1288, REFER TO PAGE 46